

Gubser Elementary School

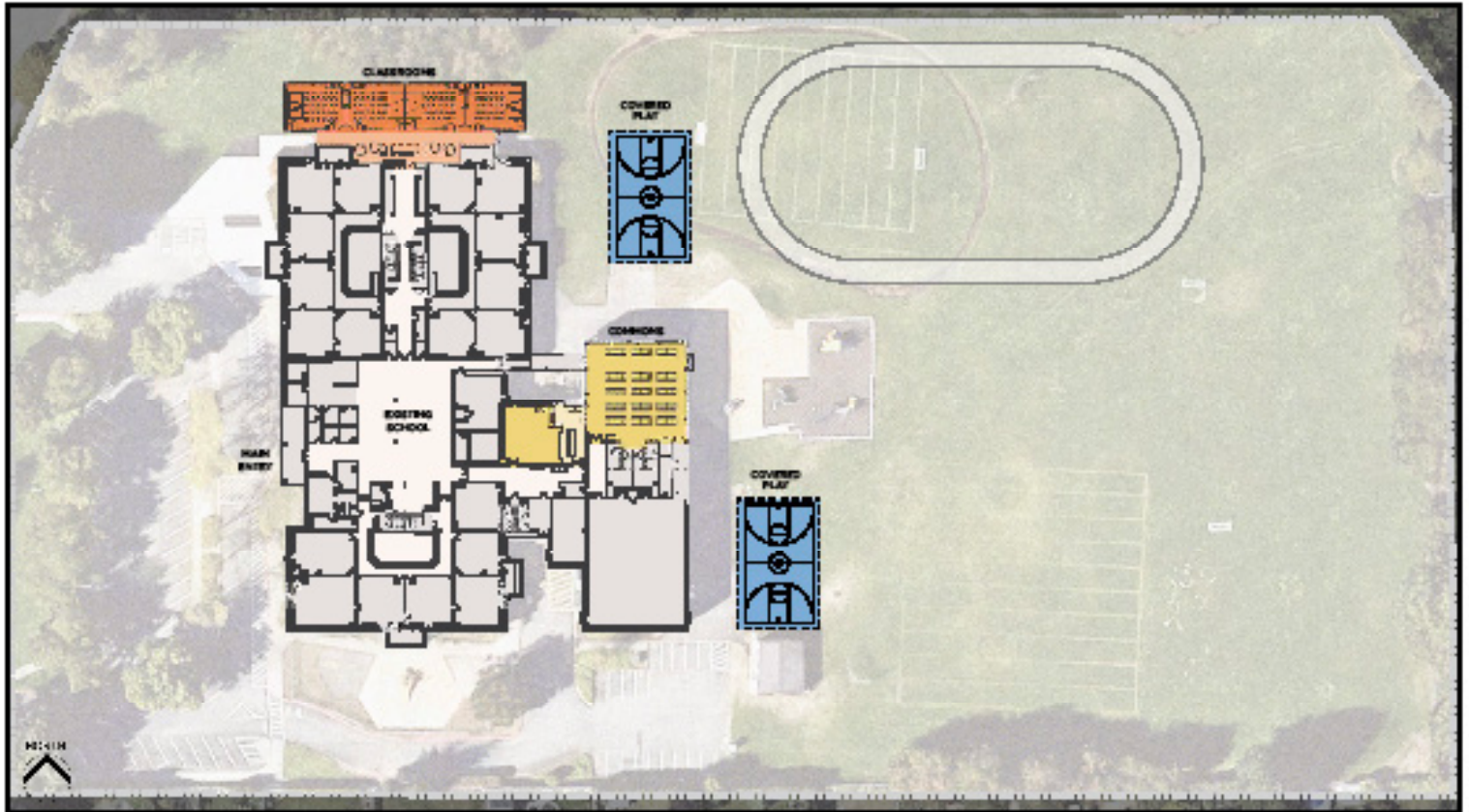

Floor Plan

2018 Bond Program

salemkeizer.org/gubser-bond

Gubser Elementary School will be expanded to relieve current overcrowding conditions and prepare for future enrollment growth.

ARCHITECT: Soderstrom Architects

CONTRACTOR: Corp Inc.

TOTAL PROJECT BUDGET*: \$5.5 million

CONSTRUCTION START: April 2019

SUBSTANTIAL COMPLETION: August 2019

Additional or Expanded Space

- New cafeteria and kitchen
- Three new classrooms and one replacement classroom
- Relocate covered play area
- Remove portable classrooms

Improvements

- Safety and security improvements at front entry
- Intercom system upgrades
- Gym improvements
- Card access system upgrade
- Expanded wireless capacity